

**- PLAN NO 1711 -**  
**FOR THE IMPROVEMENT OF**  
**LE ROY STREET**  
**- BETWEEN -**  
**HIGHLAND AVE AND NORTH LINE RANCHO SAN BERNARDINO**  
**CITY OF SAN BERNARDINO CALIFORNIA**

JULY 1947  
 R.D. FORSYTHE  
 Acting City Engineer.  
 PLAN ADOPTED October 20, 1947

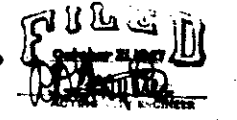

**- PLAN -**  
 SCALE 1" = 40'

**TYPICAL SECTION OF CURB TO BE CONSTRUCTED**  
 Scale 3/4" = 1'-0"  
 NOTE: A 1/2" Expansion Joint shall be constructed at intervals of 50 feet thru all Curbs ordered on this job.

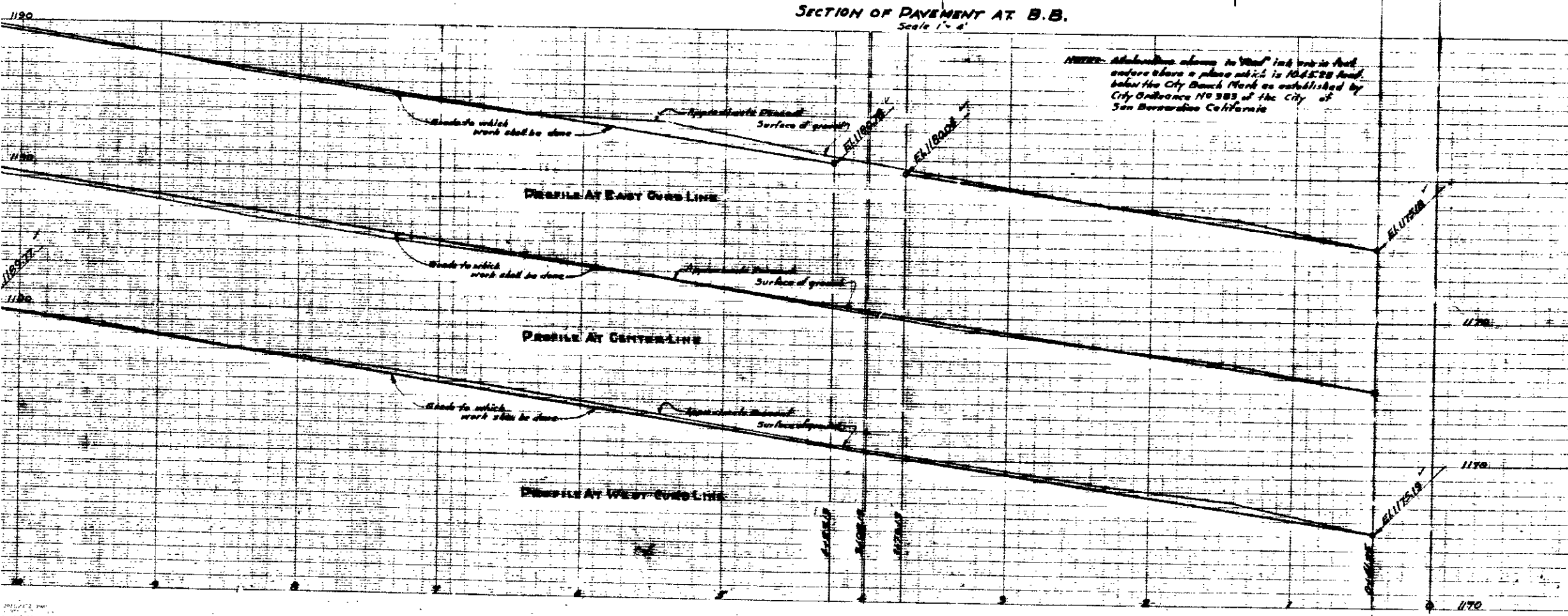
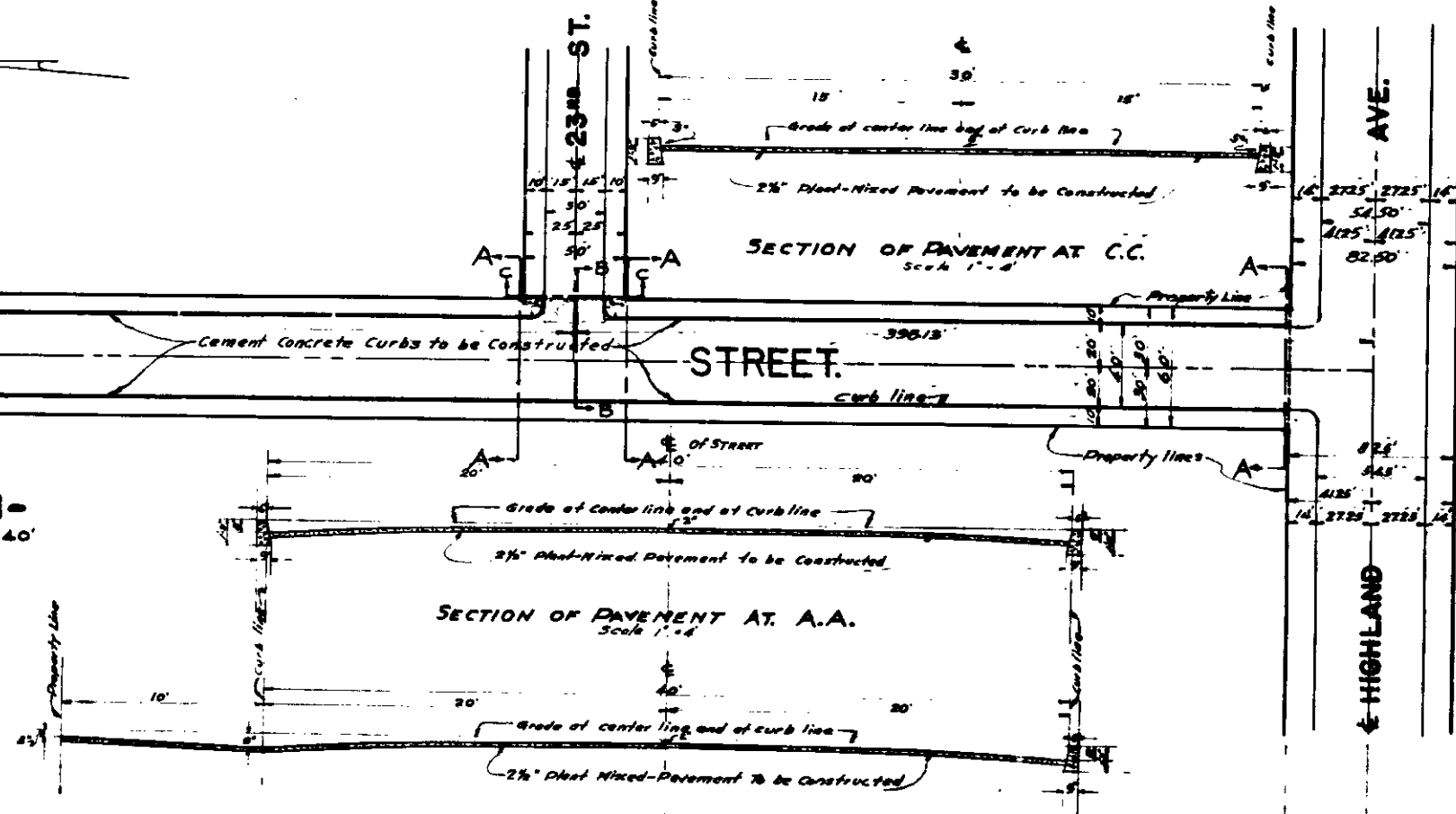

**- LEGEND -**  
 For information only  
 For Plans and as shown  
 NB means number  
 El means elevation  
 C means center line  
 ST means street  
 Cement concrete curb to be constructed shown thus in Plan. this in section.  
 2% Asphalt-Nixed Pavement to be constructed shown thus in Plan. this in section.

**- TYPE OF STREET -**  
 Le Roy Street was dedicated to the City of San Bernardino (and Le Roy Avenue) by Map of the Arraheal: Heights Tract, Recorded in Book 18, Page 5, records of San Bernardino County, California. Name changed to Le Roy Street by Resolution No. 1370.

**- GRADE RESOLUTION -**  
 Grade of LE ROY STREET was established by Resolution No. 1368, adopted 8-22-47 of the City of San Bernardino, California.

**- PROFILE LEGEND -**  
 Approximate Present Surface of ground shown by Blue line thus. Grade to which work shall be done shown by Red line thus. Scale: Horizontal 1" = 40' Vertical 1" = 4'.

NOTE: All elevations shown in this plan are in feet and are above a plane which is 104.528 feet below the City Bench Mark as established by City Ordinance No. 983 of the City of San Bernardino California.